

Model 12



Help Text-line: 512-334-6610
EMAIL: support@urbancoopcompany.com

VOICE: 877-741-COOP
Assembly Support ext 3

Front

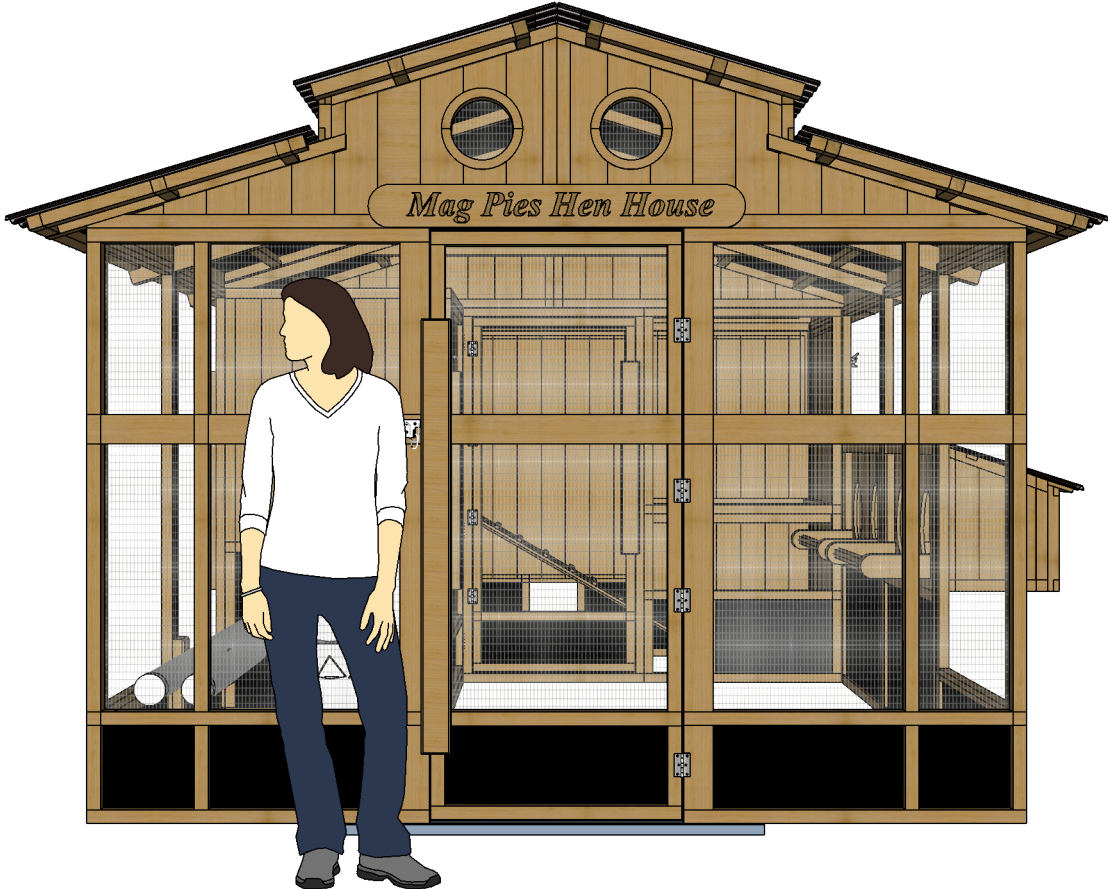

Back

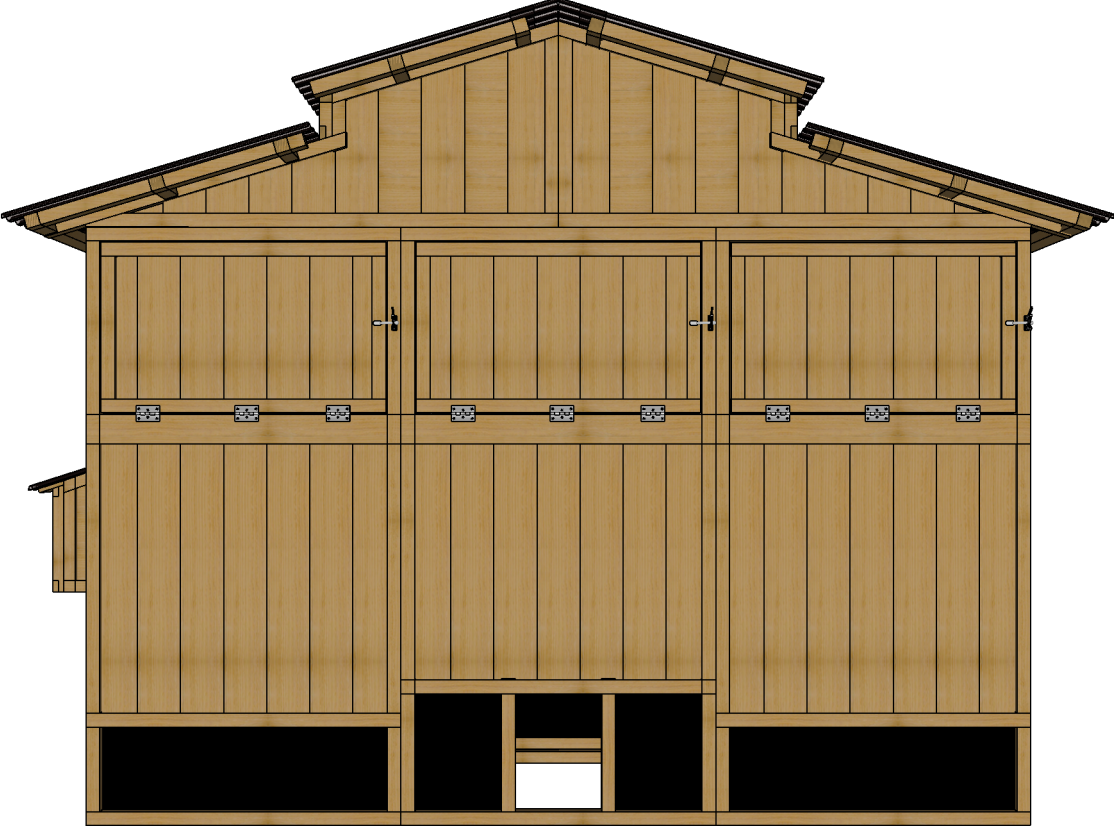

Left



Right

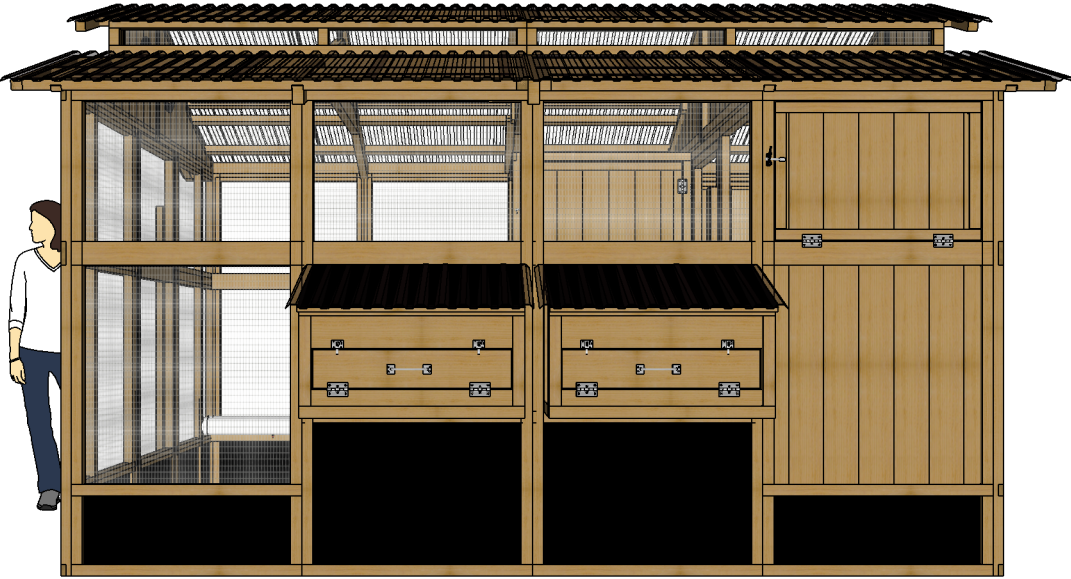

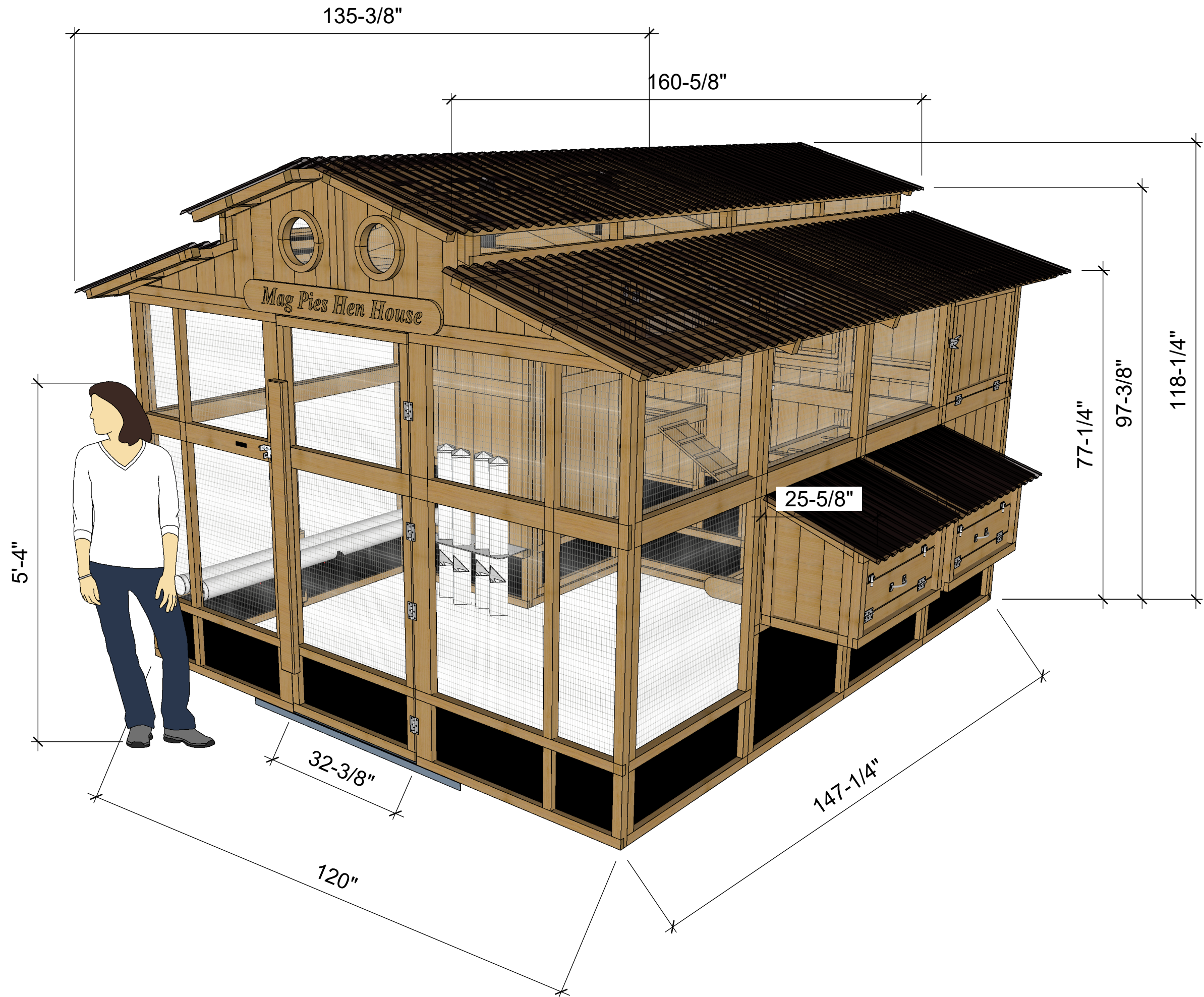



Note: If a concrete footer is poured and it is flush with ground level, you can omit pouring footer for interior roost and shed walls. If it is elevated any above ground level, you should pour footer under interior walls too for support. Pouring a concrete footer will simplify leveling and squaring and provide the best way to anchor.

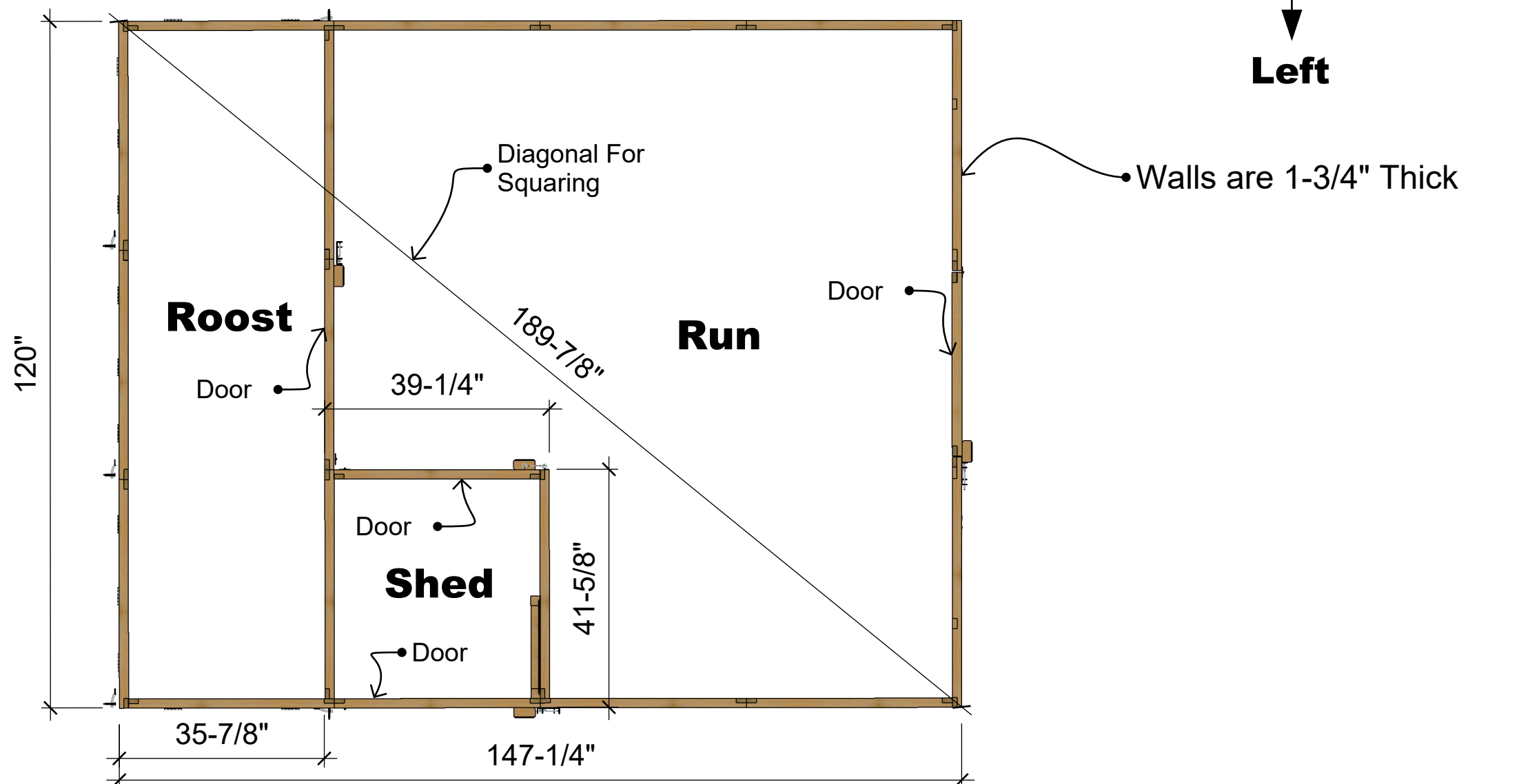

* Measurements can vary by up to 1/8" and rough cedar and shop variations can add up to an inch over long distances. A 6" wide or greater footer with walls centered will provide margin for error. If your footer is on slope, backfill inside of coop to the level of the footer with sandy loam dirt. Footer depth is a matter of preference and ground conditions. Set footer into rocky soil or at least 12" deep for anchoring purposes. Use of 1 or 2 Tapcon 3/16 (3-1/4") concrete screws in the bottom rail of each wall panel will provide good anchoring from wind. Make sure coop is level and square before anchoring.



BE CAREFUL. Coop must be anchored to avoid damage from excessive winds during and after construction.