

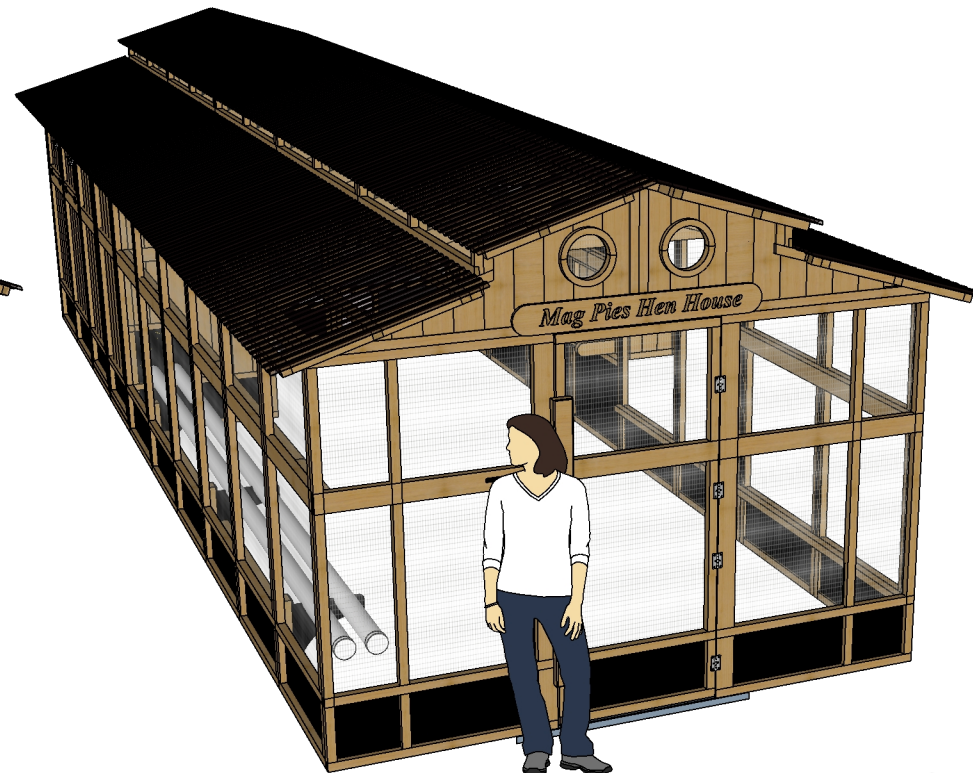

Model 20



Model 30



Model 40



Help Text-line: 512-596-5200
EMAIL: support@urbancoopcompany.com

VOICE: 877-741-COOP
Assembly Support ext 3

Front

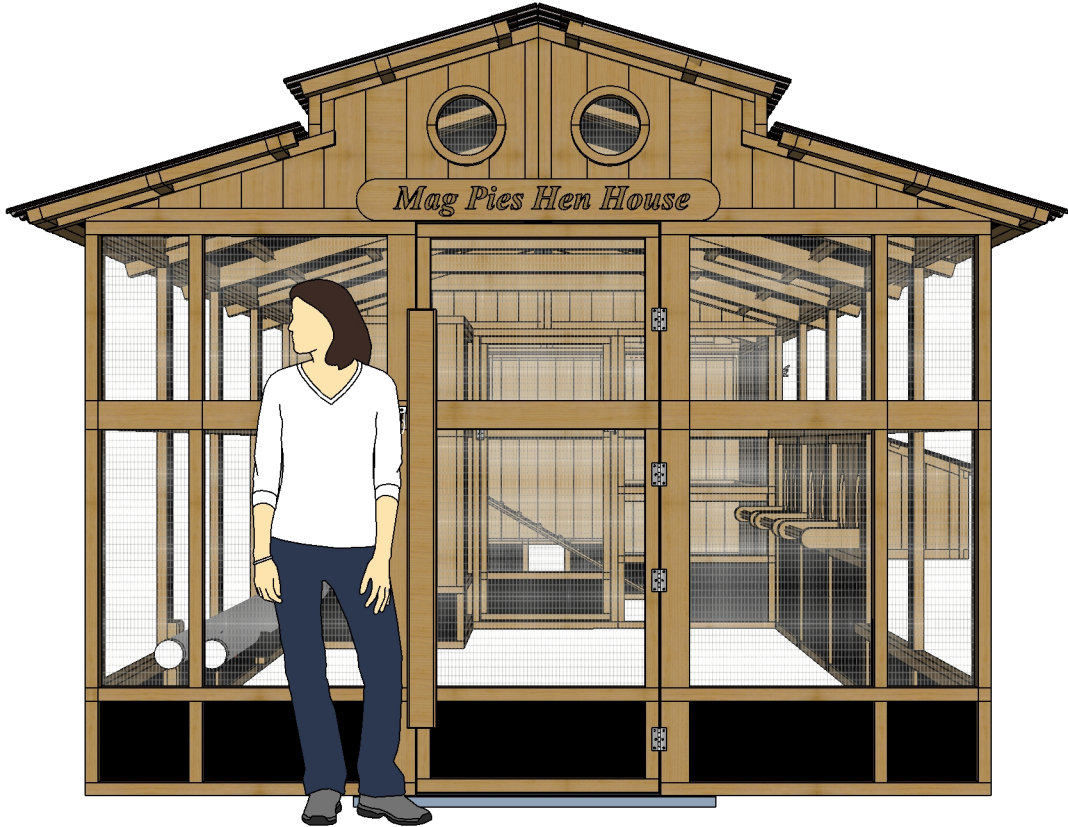

Back

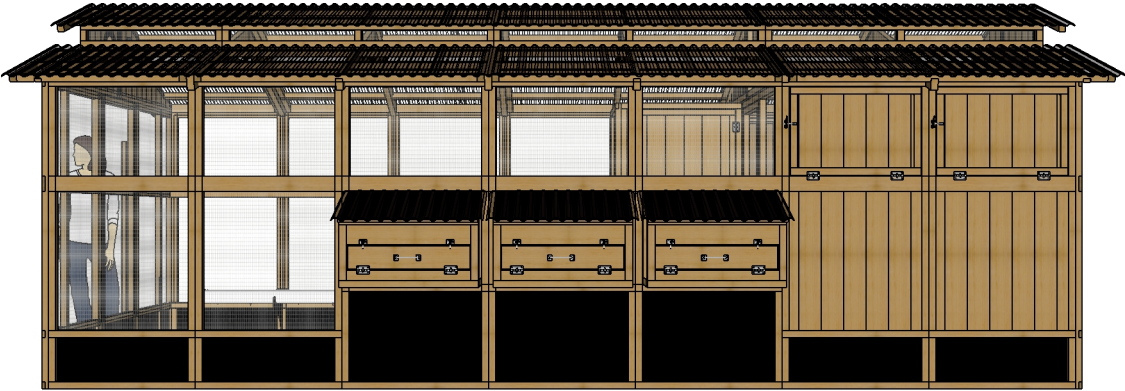
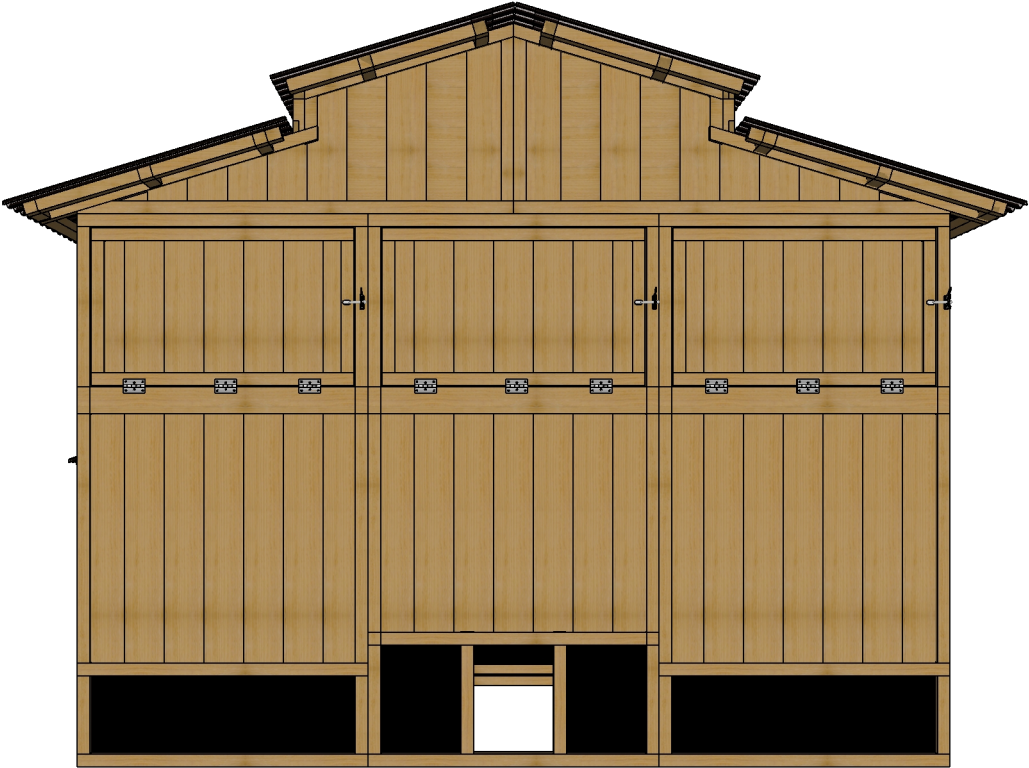

Left

Right



Model 20 coop shown...



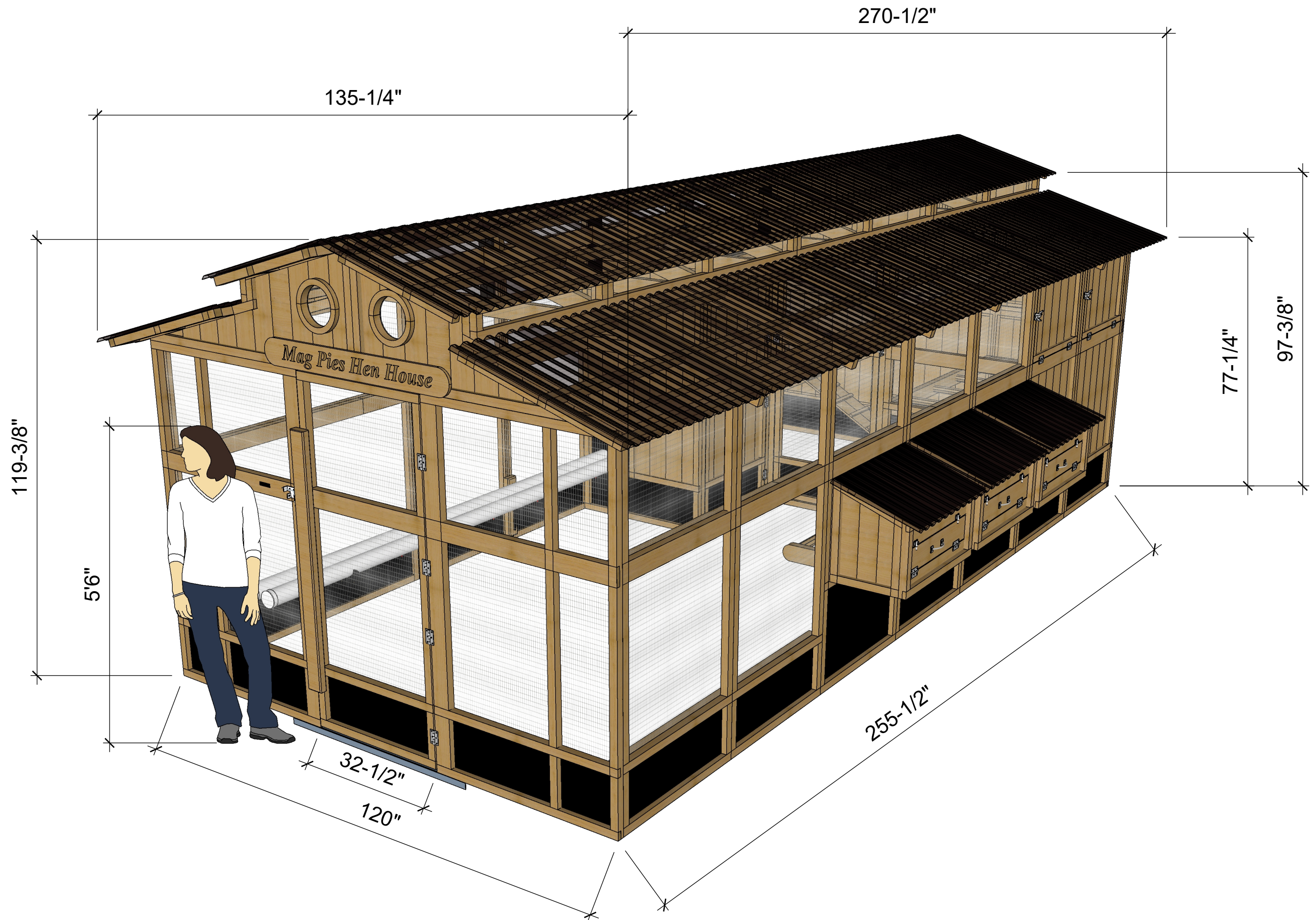

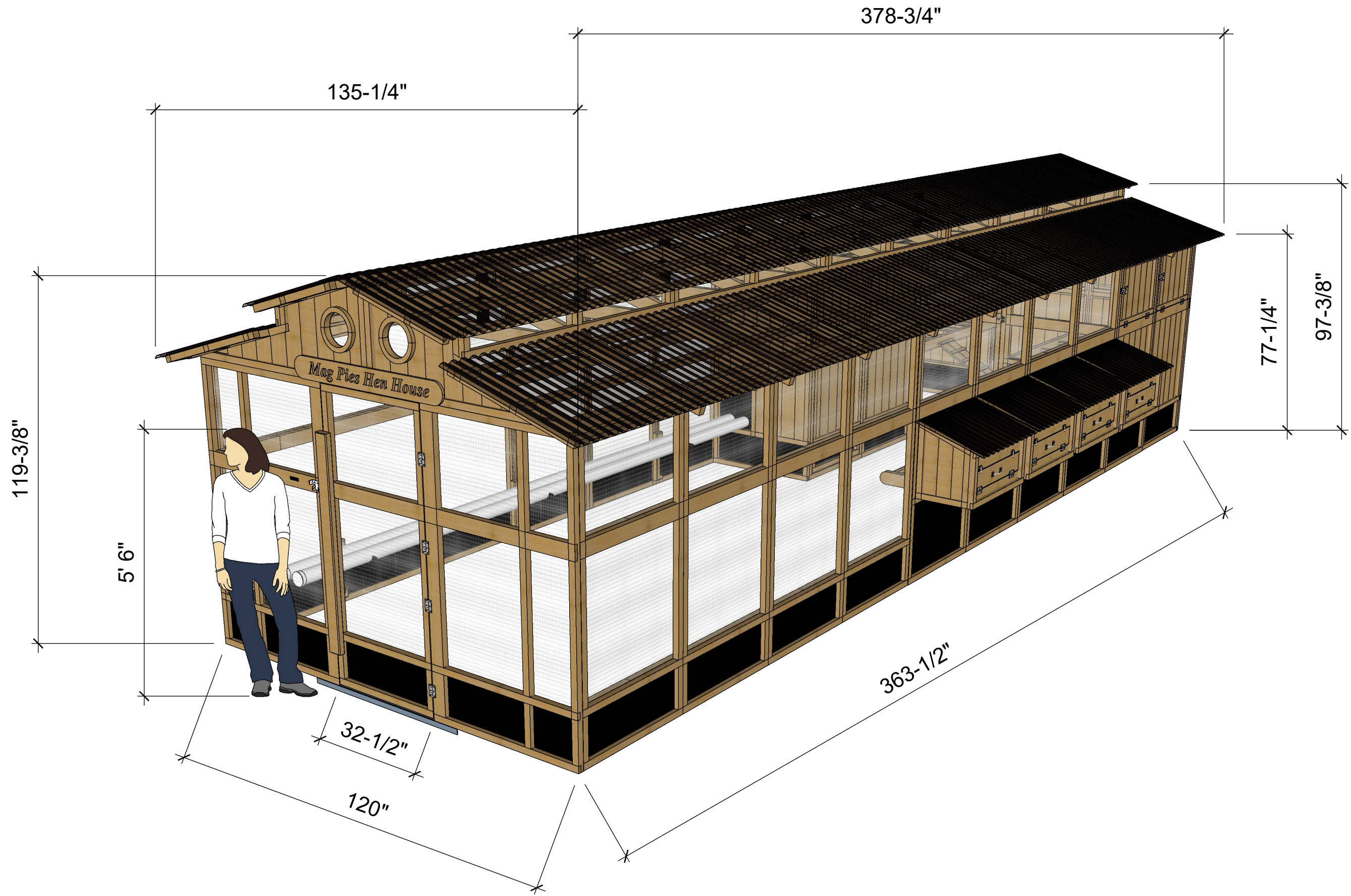

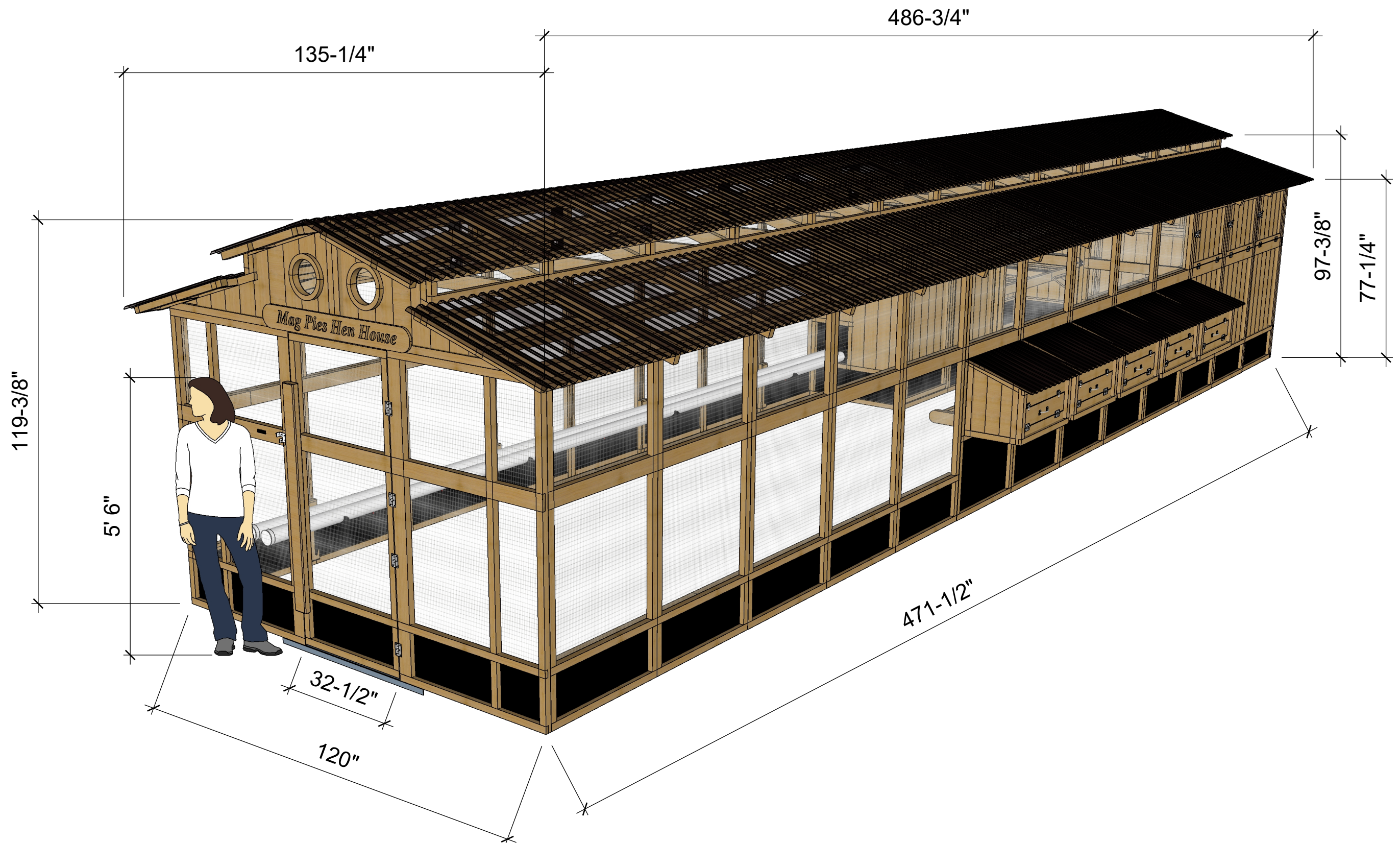



Note: If a concrete footer is poured and it is flush with ground level, you can omit pouring footer for interior roost and shed walls. If it is elevated any above ground level, you should pour footer under interior walls too for support. Pouring a concrete footer will simplify leveling and squaring and provide the best way to anchor.

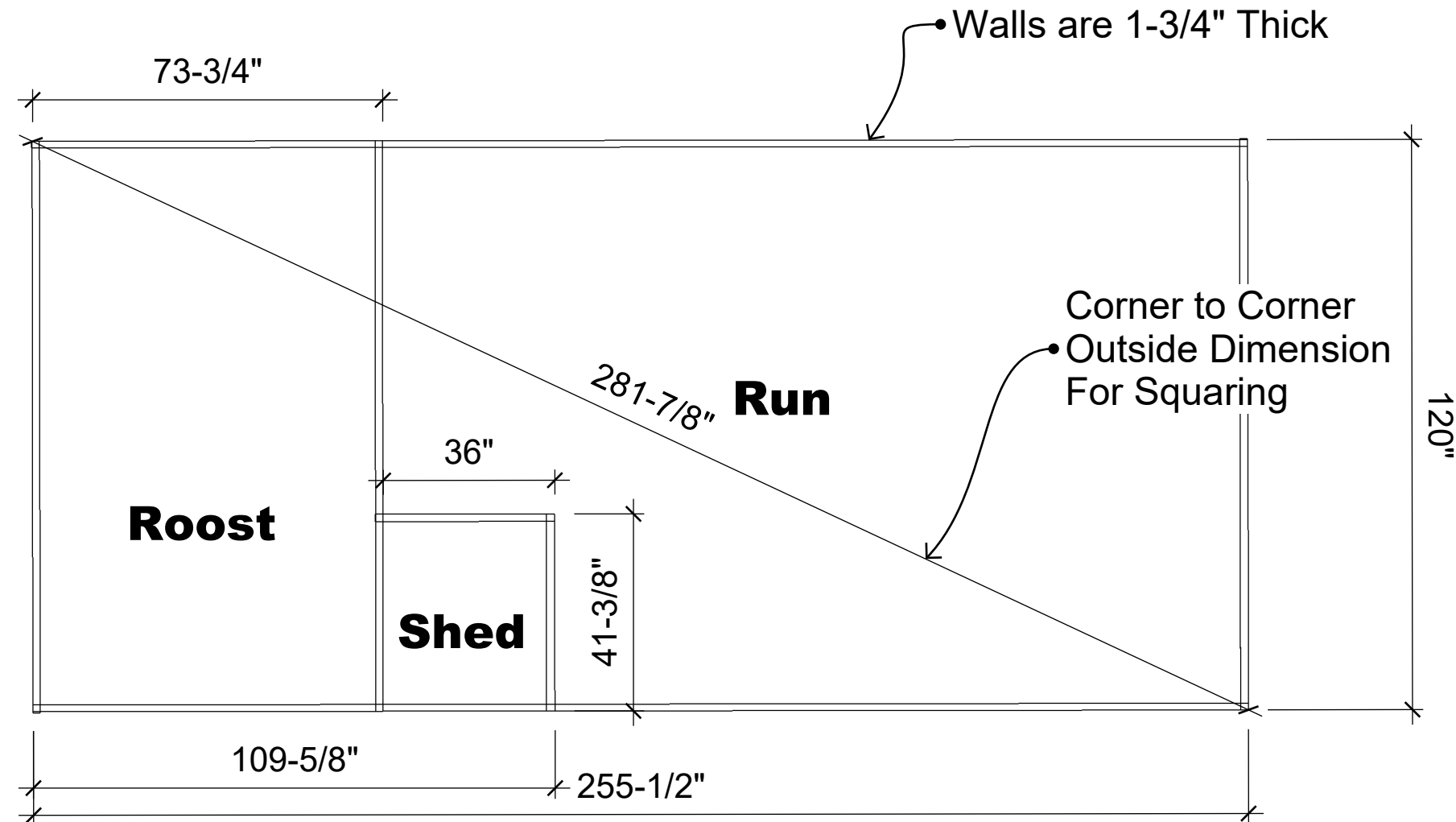
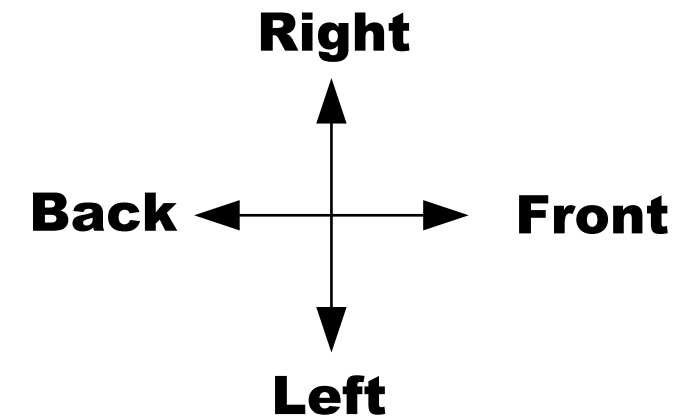

* Measurements can vary by up to 1/8" and rough cedar and shop variations can add up to an inch over long distances. A 6" wide or greater footer with walls centered will provide margin for error. If your footer is on slope, backfill inside of coop to the level of the footer with sandy loam dirt. Footer depth is a matter of preference and ground conditions. Set footer into rocky soil or at least 12" deep for anchoring purposes. Use of 1 or 2 Tapcon 3/16 (3-1/4") concrete screws in the bottom rail of each wall panel will provide good anchoring from wind. Make sure coop is level and square before anchoring.



BE CAREFUL. Coop must be anchored to avoid damage from excessive winds during and after construction.



Note: If a concrete footer is poured and it is flush with ground level, you can omit pouring footer for interior roost and shed walls. If it is elevated any above ground level, you should pour footer under interior walls too for support. Pouring a concrete footer will simplify leveling and squaring and provide the best way to anchor.

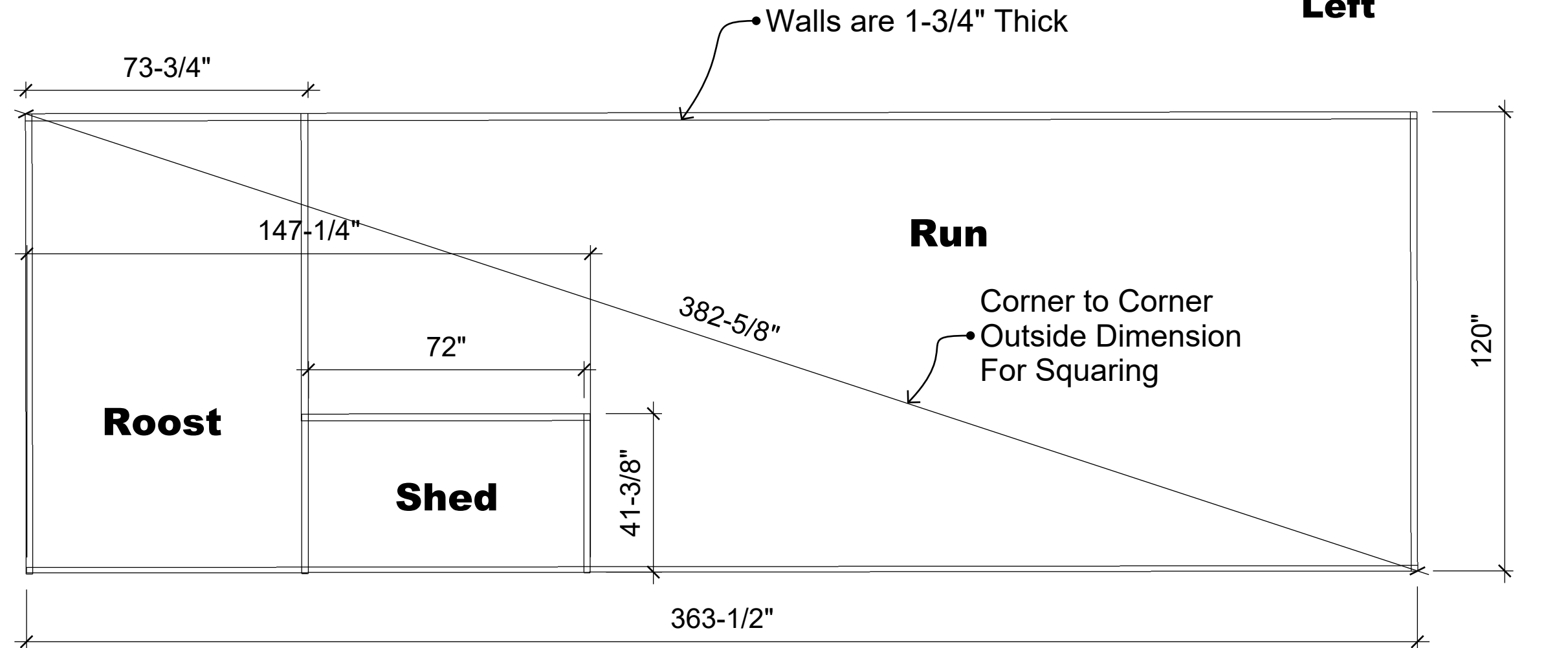

* Measurements can vary by up to $\frac{1}{8}"$ and rough cedar and shop variations can add up to an inch over long distances. A 6" wide or greater footer with walls centered will provide margin for error. If your footer is on slope, backfill inside of coop to the level of the footer with sandy loam dirt. Footer depth is a matter of preference and ground conditions. Set footer into rocky soil or at least 12" deep for anchoring purposes. Use of 1 or 2 Tapcon 3/16 ($3\frac{1}{4}"$) concrete screws in the bottom rail of each wall panel will provide good anchoring from wind. Make sure coop is level and square before anchoring.



BE CAREFUL. Coop must be anchored to avoid damage from excessive winds during and after construction.



Note: If a concrete footer is poured and it is flush with ground level, you can omit pouring footer for interior roost and shed walls. If it is elevated any above ground level, you should pour footer under interior walls too for support. Pouring a concrete footer will simplify leveling and squaring and provide the best way to anchor.

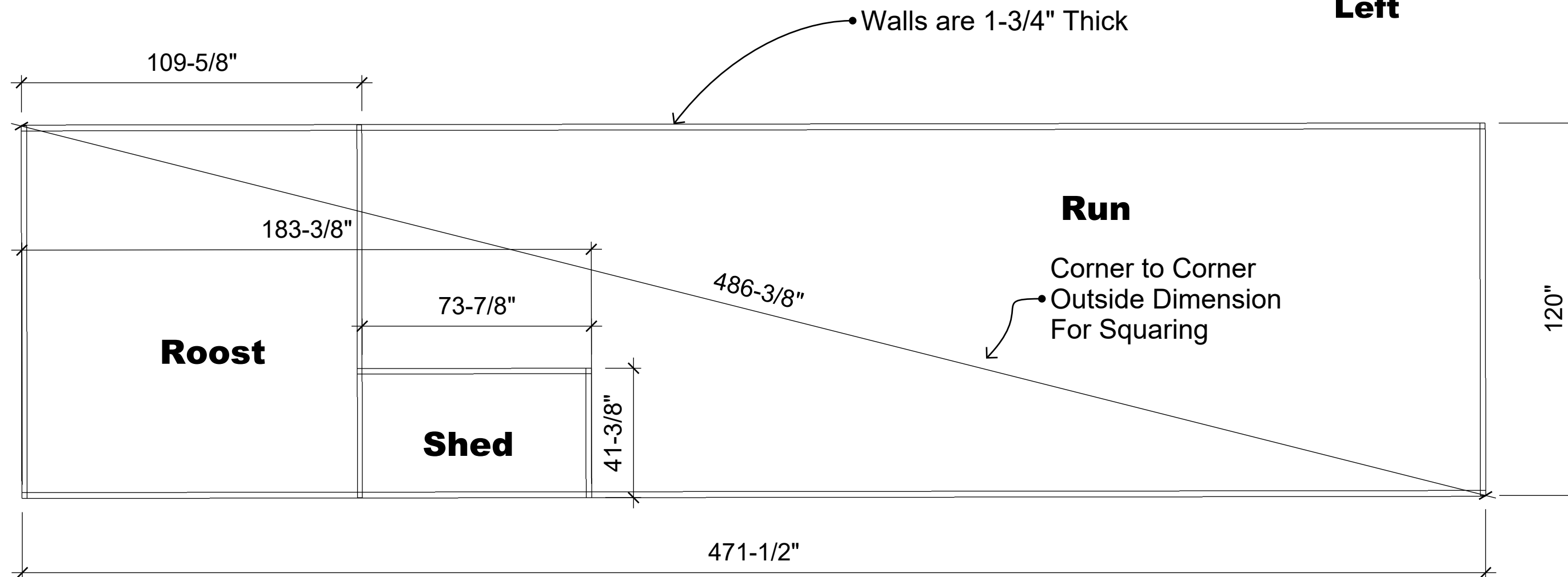

* Measurements can vary by up to 1/8" and rough cedar and shop variations can add up to an inch over long distances. A 6" wide or greater footer with walls centered will provide margin for error. If your footer is on slope, backfill inside of coop to the level of the footer with sandy loam dirt. Footer depth is a matter of preference and ground conditions. Set footer into rocky soil or at least 12" deep for anchoring purposes. Use of 1 or 2 Tapcon 3/16 (3-1/4") concrete screws in the bottom rail of each wall panel will provide good anchoring from wind. Make sure coop is level and square before anchoring.



BE CAREFUL. Coop must be anchored to avoid damage from excessive winds during and after construction.

roost&root
Find your inner farmer.

Assembly Instructions
Heritage Series Chicken Coops™
V1.0 Spring 2023
Copyright © Roost & Root
all rights reserved.

Footer Illustration
Model 40 - Birdseye
View

40

Page
07